



Quality for the world

CS M15

MANUAL FLEXIGUN



Version 1 : 07/2001

OWNERS Manual

Cassese / Communication

Z 8657

OPERATION

Your CS M15 is factory set. Replacement Points are available in boxes of 3,400.

INSERTING POINTS

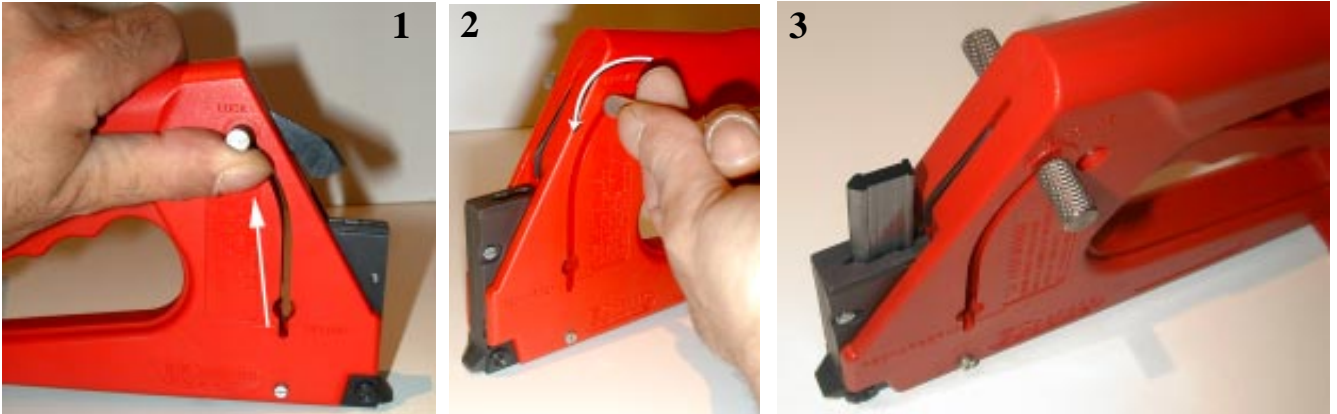

- 1- To insert a stack of flexible points, pull follower knobs up and rotate to the locked position. (see fig1 & fig2)
- 2- Insert points into the slot in the magazine and release the follower knob so it can apply pressure to the stack of points. (see fig3)



- 3- Reload points when the follower reaches the RELOAD position. There are 170 points per stack and 3,400 per box.

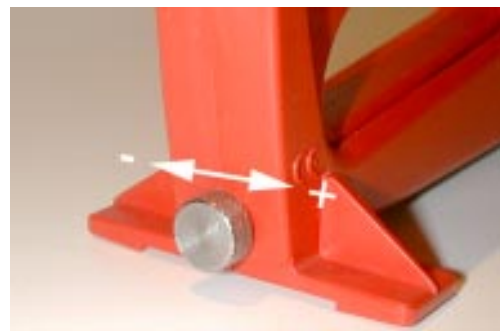

PRESSURE ADJUSTMENT

The pressure adjustment will affect the depth of penetration of the point in wood. Although factory set accommodate most frames, the depth can be increased by turning the knob clockwise and decreased by adjusting it counterclockwise.

GENERAL OPERATION

- 1- When framing, back up the wood with a firm object to assure proper penetration of the point and avoid snocking the frame.

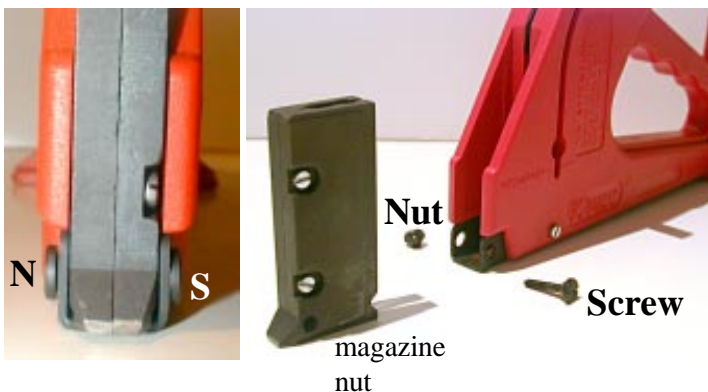

- 2- ALWAYS keep the magazine loading area free of foreign matter.

MAINTENANCE & TROUBLE SHOOTING

PROBLEM	PROBABLE	ACTION
Does not fire point	Out of points	Reload new stack of points.
	Point jammed	Remove points and magazine. Remove jammed points and clean magazine cavity.
	Magazine locking screw loose	Tighten nut firmly.
Fires double points	Magazine locking screw loose	Tighten nut firmly.
Point penetration not deep enough	Frame not firmly backed up	Use firm backing
	Pressure adjustment too low	Readjust pressure screw clockwise.

If you need assistance resolving any difficulties please contact your distributor.